

Leica
Geosystems



DISTO™ Plan App

How to connect

How to connect

Overview

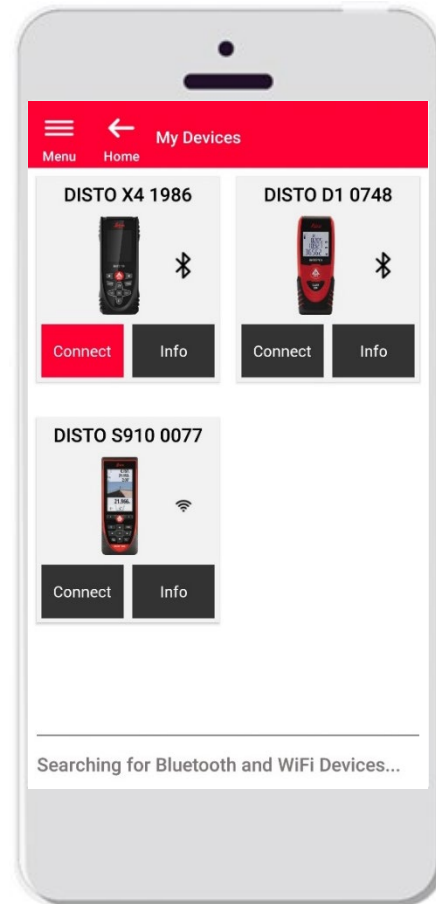
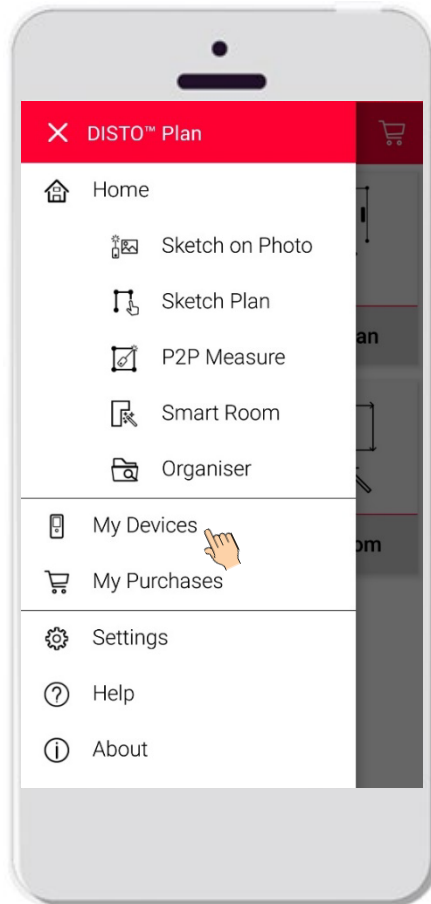

- In **My Devices** it is possible to manage and connect to your DISTO™s
- Swipe on the left side of your smartphone or tablet and tap on “My Devices”
- Features:
 - Visualize the DISTO™ you have paired
 - Connect to the DISTO™s
 - Get more information about your DISTO™s

How to connect Compatibility



DISTO™ Plan is compatible with all DISTO™ devices supporting Bluetooth® Smart functionality or WiFi™



S910



D810



D510



X4



X3



D2



D110



D1

- when it has to be right



How to connect

First connection with DISTO™ - Bluetooth

1. Turn on the **Bluetooth** on your DISTO™
2. Enable the Bluetooth from your phone/tablet in **Settings**

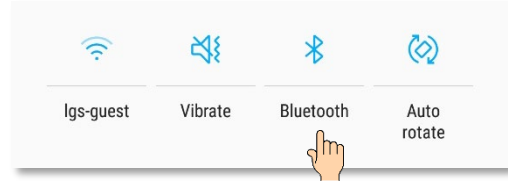

3. Open **My Devices**

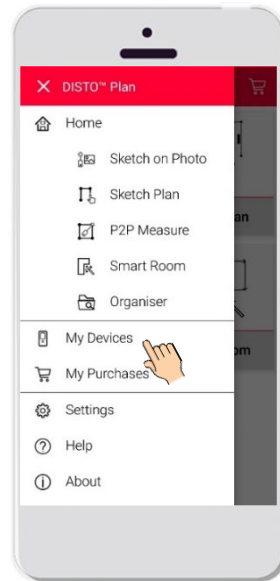

4. All the DISTO™s available in the range will be shown
5. DISTO™ **Serial Number** and model are shown for each device in the range available for connection
6. Tap **Add** to connect with the DISTO™
7. When your device connects, the blue Bluetooth symbol and a thumbnail will be displayed

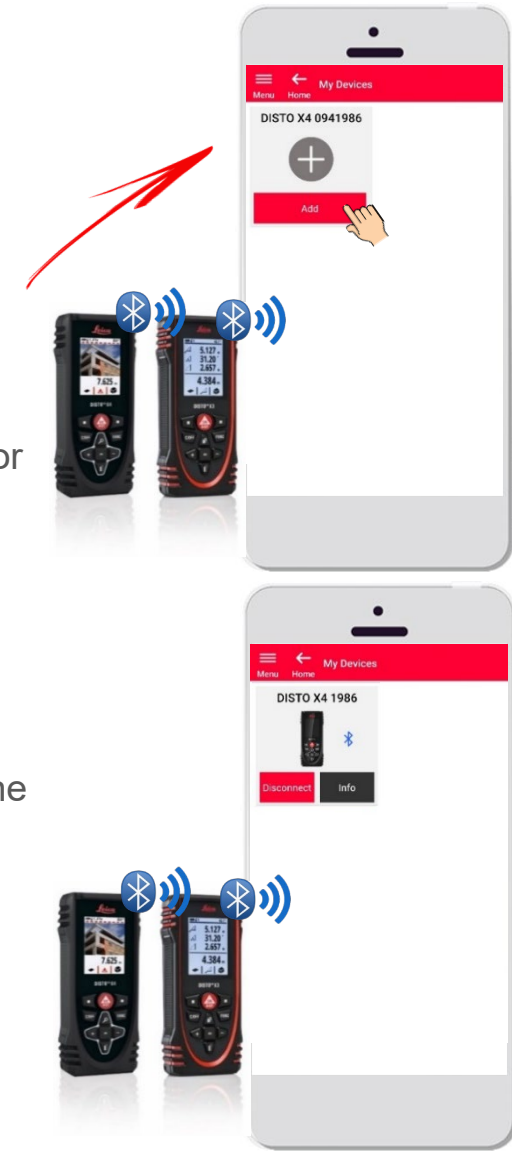

- when it has to be **right**

How to connect

First connection with DISTO™ – WiFi (DISTO™ S910)

1. Turn on the **Wi-Fi** on your DISTO™ S910
2. Open the Wi-Fi connections on your smartphone/tablet and select your DISTO™ S910 from the available networks



3. Open **My Devices**

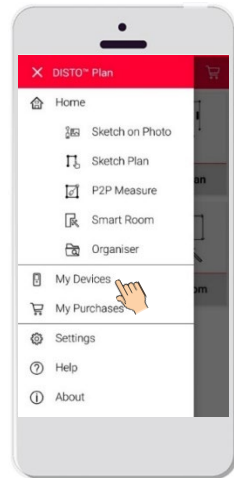

4. All the DISTO™s available in the range will be shown
5. DISTO™ **Serial Number** is shown for each device in the range available for connection
6. Tap **Add** to connect with the DISTO™
7. When your device connects, the blue Wi-Fi symbol, DISTO™ model and a thumbnail will be displayed



After connection with DISTO™ via Wi-Fi your Internet connection will be lost

- when it has to be **right**

Leica
Geosystems

How to connect

Connect with DISTO™

- Information about DISTO™ will be saved after first connection
- The connect button turns red when the DISTO™ is available for connection
- The Bluetooth or the Wi-Fi symbol turns blue when device is connected
- How to disconnect:
 - Tap on **Disconnect**
 - Or turn off your DISTO™ or close the app
 - Or turn off the Bluetooth or Wi-Fi on the smartphone/tablet
- Tap on **Info** for more details about your DISTO™

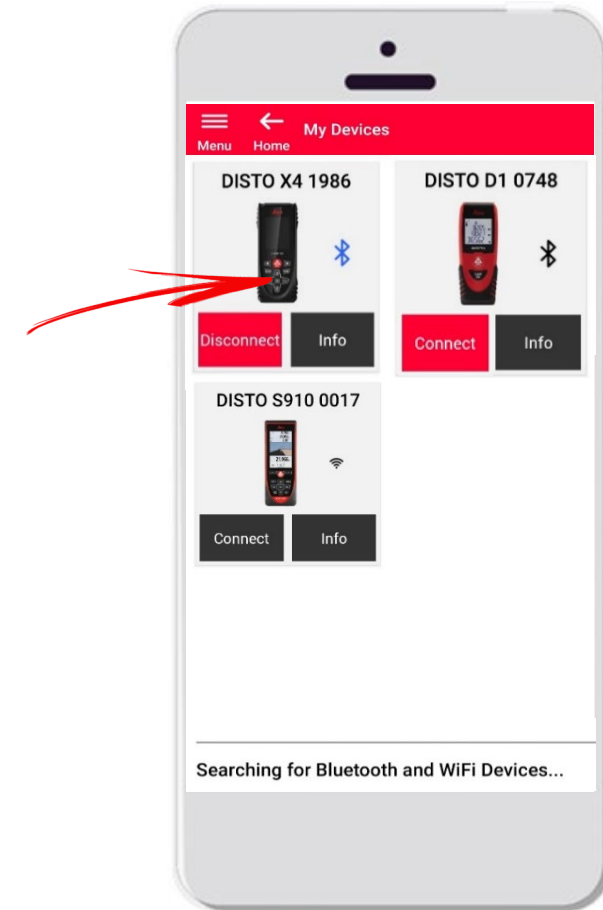

- when it has to be right

How to connect Info

Tap on **Info** for more details about your DISTO™

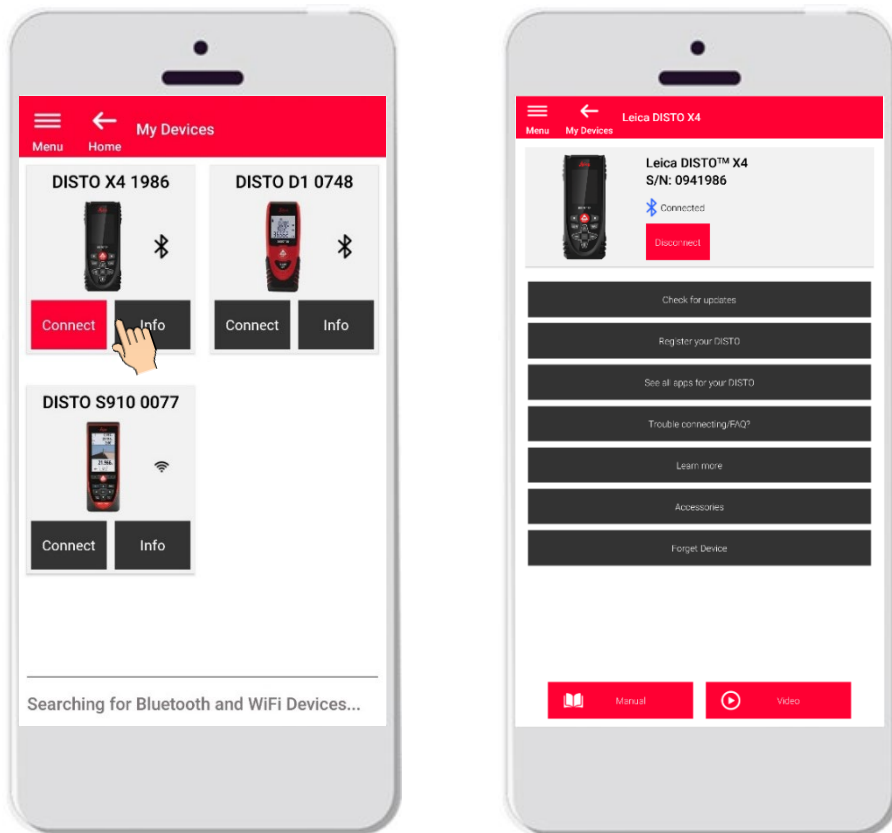

- **Check for updates:** check firmware updates (only for DISTO™ X3, X4 and the DST 360 adapter)
- **Register your DISTO™:** go to myWorld portal to register your device
- **See all apps for your DISTO™**
- **Trouble connecting/FAQ?:** for solving common issues
- **Learn more:** go to the webpage of your DISTO™
- **Accessories:** see the vast choice of accessories for your DISTO™
- **Forget Device:** remove your DISTO™ from the list of the devices available for connection
- **Manual:** for instructions about your DISTO™
- **Video:** watch the video about your DISTO™

- when it has to be **right**

How to connect

Firmware update for DISTO™ X3, X4

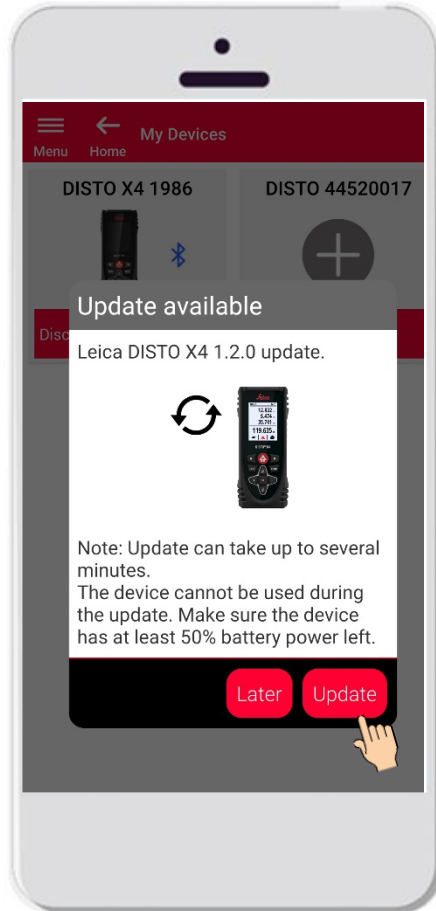

- Connect DISTO™ X3 or X4
- If a DISTO™ Firmware update is available, it will be automatically show on screen
- Update is possible only with internet connection and if DISTO™ battery is charged at least 50%
- Tap **Later** to postpone the upgrade to the next app start
- Select **Update** to start immediately

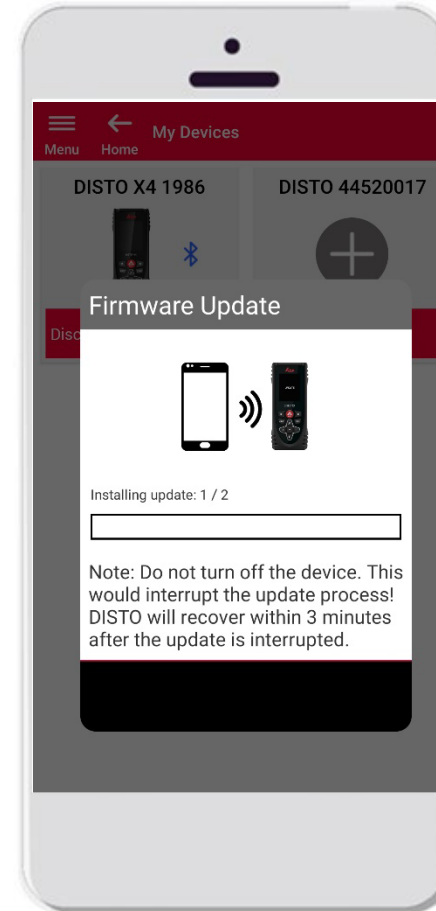

- The DISTO™ firmware will be updated automatically
- The whole process may take several minutes!
- During this process your DISTO™ will be unavailable – it will recover within 3 minutes after the update is completed
- Do not turn OFF your DISTO™ during the update
- A message **Update successful** will be displayed after the process is completed



- when it has to be right

How to connect Info – Check for updates

Check firmware updates for DISTO™ X3, X4 and the base Leica DST 360

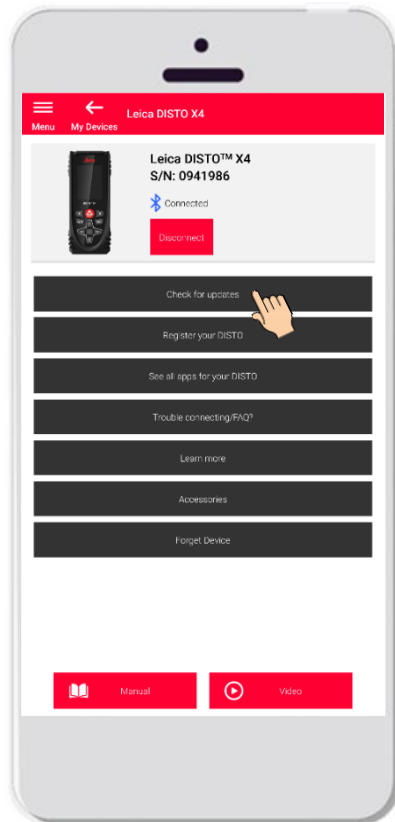

If there are updates available,
the last firmware version will be ready
to download onto your device

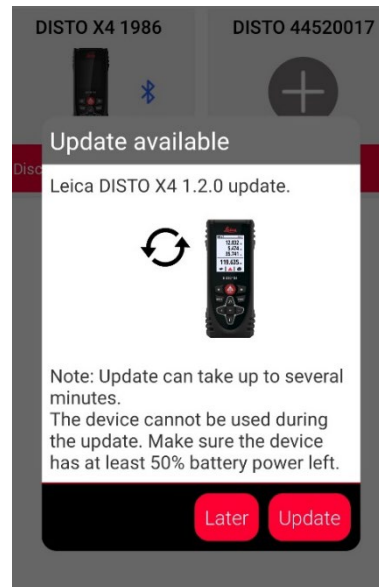

A message will be displayed if no
updates are available

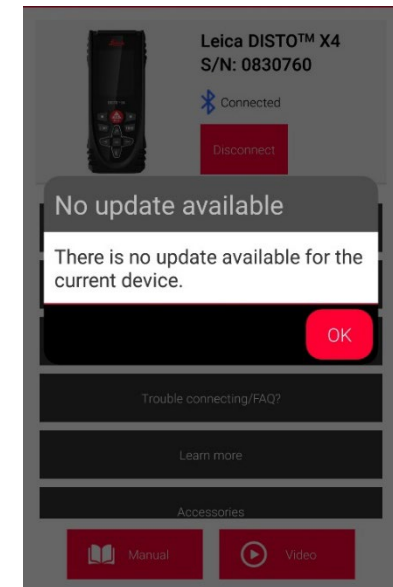

Leica
Geosystems



DISTO™ Plan App

How to connect